

puzer
KESKUSPÖLYNIMURI



Puzer Easy

The small and handy central vacuum cleaner of the Puzer collection

**PLEASE READ THIS MANUAL BEFORE
USING THE VACUUM CLEANER**

USER MANUAL

PUZER EASY

CONTENTS

Safety instructions	2
Specifications	3
Mounting the central unit	4
Using the system	5
Servicing	6
Troubleshooting	7
The features of the Puzer Easy circuit board	8
Installation of additional suction outlets	9

Important safety instructions



PLEASE KEEP THIS MANUAL FOR FUTURE USE

NB! Read all the safety instructions and warnings before using your central vacuum cleaner.

- This central vacuum cleaner is designed for vacuuming in dry areas do not use it for vacuuming liquid.
- Do not vacuum near smoke, glowing embers, fire or hot ashes.
- Do not vacuum in areas that may contain burning or easily flammable liquids and gases.
- Always pull out the plug before changing the filter or dust bag, and before servicing.
- When you pull out the plug, pull by the plug, never pull the cord.
- The outlet and the plug shall be in a clearly visible place.
- Do not mount the vacuum cleaner into too narrow a place. The minimum height of the space 530mm Width 480mm.

- Do not vacuum sharp objects, such as glass or needles as they may get stuck in the pipework.
- Do not cover the central unit.
- Always comply with the instructions in this manual.
- The servicing of the vacuum cleaner must only be carried out by an authorized servicing company. Use only spare parts and accessories recommended by the manufacturer. Never try to make any alterations into the vacuum cleaner.
- Never use a central vacuum cleaner with a faulty electrical wire. The central vacuum cleaner has a special wire that should always be replaced with a wire of the same type. They can be purchased at authorised repair shops.
- Remember that the central vacuum cleaner is not a toy.
- Never vacuum without a dust bag.
- Always pull out the hose from the suction outlet after you finish vacuuming.

TECHNICAL SPECIFICATIONS

Puzer Easy central vacuum cleaner



Puzer Easy is developed especially for apartment and row houses or for renovation sites. The exhaust air of the Easy vacuum cleaner is directed through a washable HEPA 12 allergy filter to the installation space. A separate exhaust pipe is not needed. The mounting of the equipment does not require other operations than fastening it to the wall with four screws. The benefit of Easy is that the exhaust air does not circulate the air in the whole apartment like with a normal vacuum cleaner. Easy on is very silent and effective.

Motor power max.	1200 W
Air power max.	165 m ³ /h
Vacuum max.	28 kPa
Suction power max.	550 W
Noise level min.	66 dB(A)
Height / required space	46/53 cm
Width / depth	46/28 cm
Overheat protectors	is
Fuse (automatic)	10 A (slow)
Operating voltage min – max	V 50Hz 210-244
Hepa 12 filter	is
IP class	IPX0
Volume of the container	8l



INSTALLING THE CENTRAL VACUUM CLEANER

There are detailed instructions on how to mount the Puzer dust piping system and suction outlets. These instructions are included in your piping system delivery.

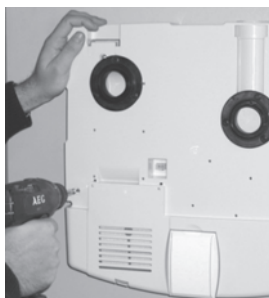

1. Fasten the filter unit with four screws to their correct locations. Use wall brackets depending on the material.



2. Tighten the fastening screws.



3. Fasten the connector of the weak current wire to the counter piece of the filter unit. The connector of the weak current wire can be found separately in the package.



4. Push the central unit directly towards the filter unit. Push the central unit toward the filter unit.



5. Place the central unit directly towards the filter unit. Make sure that the rubber pieces behind touch their counterpieces.



6. Put the latches to their correct places. Support the central unit with your other hand so that it will not fall.



7. Push the latch all the way to the bottom.



8. Place the other latch to its place. Repeat points 5 and 6.



9. Fasten the weak current wires and the mains cable to the circuit board of the machine.

INFORMATION

In case you need any help with planning and installing your central vacuum system, please contact the dealer or the manufacturer in the following address.

Manufacturing and marketing:

KP-TEKNO OY

Masalantie 365, 02430 Masala, tel.+358 9 296 5070, fax +358 9 221 5932
e-mail: puzer@puzer.fi, www.puzer.fi

USING THE SYSTEM

Puzer Central Vacuum Cleaner is easy to use. If your system includes a suction hose with a handle switch, push the hose to the suction outlet as indicated by the image (1). Now you can start and stop the system using the switch in the handle of the suction hose. If you are using a suction hose without a handle switch feature, the system starts when you connect the suction hose to the suction outlet. The central vacuum cleaner is designed for traditional vacuuming of household dust and litter. When vacuuming an area that is very dusty or wet, a pre-separator must be used. (2).

Vacuuming construction or gypsum dust or ashes is strictly forbidden without a pre-separator.



THE OPERATION PRINCIPLES OF THE CENTRAL VACUUM CLEANER

When the user is connected to the system by connecting the suction hose to the wall outlet, an electronic signal from the wall outlet is sent to the central unit to start the system. The central unit starts, and the vacuum created by the system causes suction in the pipings.

The central unit stays on, until the hose is pulled out from the suction outlet. The vacuum cleaner can be equipped with a hose featuring a handle switch to start the vacuum.



MAINTENANCE OF THE CENTRAL VACUUM CLEANER

MAINTENANCE AND CLEANING OF THE FILTER



1. When changing/cleaning the filter, turn the locking lever downward.



2. Pull the cover out and slightly downward.



3. Pull the filter out in a slightly diagonal position the same way as it is in its place. Replace it in the same way in a slightly diagonal position.



4. Push the upper edge of the filter cover back to its position. Press the lower edge down and turn the locking lever up.

Remember to let the filter dry after washing it before replacing it.



CLEANING THE FILTER

Warning: Do not scratch, rub or use high pressure water when cleaning the filter. This may damage the filter permanently. There may also be some discoloration after the wash.

1. Remove the filter carefully from the plastic frame in the vacuum cleaner.
2. Rinse the dirty side of the filter under a water tap with lukewarm, low pressured water in the direction of the folds so that the water can run along the lamellas. (see picture)
3. Turn the filter and wash from the opposite direction as indicated by the image. Continue rinsing, until the filter is clean.
4. Shake the water carefully off the filter and let it dry for at least an hour before placing the filter back to the vacuum cleaner.

Do not place a wet filter to the vacuum cleaner.

INSTALLATION OF ADDITIONAL SUCTION OUTLETS

1. In case additional suction outlets are installed to the system, remove the plug in the upper corner of the unit. This way you can take an additional box from the filter unit e.g. behind the wall or to other rooms.



2. When using the original 42 mm polypropylene pipe, first place a washer to the hole. The installation can also be started with the corner pieces.



3. Connect the weak current connection of the additional outlet to the terminal block behind the wall rack.



TROUBLESHOOTING

NOTE:

230 V ELECTRICAL WORK CAN ONLY BE CARRIED OUT BY A PROFESSIONAL WHO IS AWARE OF ALL THE SAFETY REGULATIONS.

THE VACUUM CLEANER DOES NOT START

- Is the central unit connected to the mains?
- Is the wall socket supplied with electricity?
- Is the low voltage cable connected to the filter unit of the central vacuum cleaner?
- Have you got the right hose? Original hoses have the right contactors
- Does the vacuum cleaner start, if you try another suction outlet? If the vacuum cleaner starts, the fault is in the electrical connections of the suction outlet. Detach the outlet and check the wiring connections.
- If you have installed additional suction outlets, does the vacuum cleaner start when you try from another suction outlet? If the vacuum cleaner starts, the fault is in the electrical connections of the suction outlet. Detach the outlet and check the wiring connections.
- The vacuum cleaner is equipped with a overheat protection function which may have tripped. Wait for ten minutes until the vacuum cleaner cools down. If the protection function comes on again, contact an authorized service company.
- Has the automatic fuse of the vacuum cleaner tripped? Press it and restart.

The main fuse shall be of 10A

Model:

Product number:

Serial number/ date:

Date of purchase:

KEEP THE RECEIPT

LOW SUCTION

- Are all the suction outlets properly fitted?
- Has something got stuck in the suction outlet?
- Is the dust bag full?
- Is the cover properly placed?
- Are the suction pipes blocked?
- Is the hose blocked?
- Is there a leak in the pipework?
- Are the O rings of the suction outlet in their place?

SERVICE AND SPARE PARTS

If your vacuum cleaner needs servicing or spare parts, please mention the technical data on the type shield. The shield is located inside the machine by the dust bag. Write down the information below. That way they are always within reach.

The guarantee of the central unit is 5 years.



The symbol marked to the product or package indicates that this product must not be handled as household waste. Instead, the product

shall be submitted to a suitable recycling point that takes care of the recycling of electrical and electronic equipment. The appropriate disposal of this product helps to prevent any harmful effects on the environment and health, which may be caused by the inappropriate handling of this product. More exact information on the recycling of this product can be found in the local municipal office, household waste service or the place where you have purchased the product.

FEATURES OF THE PUZER EASY CIRCUIT BOARD

1 - SOFT START

The start peak is limited with a TRIC relay, this way the start power is delivered to the motor with a delay of 1 second. The start voltage is significantly smaller and the stress of the fuses, network and motor decreases.

2 - LOW VOLTAGE LED AUTOPOLARITY *2

The green light in the machine of the pendant is always on when the voltage is connected. (i.e. the plug is in the outlet)

3 - OPERATION HOUR COUNTER *3

By using EEPROM technology (erasable programmable ROM), the card registers two types of time, which can be checked by the user only by looking at two separate LEDs located in the protective board of the circuit board. **a.** Short time **b.** Total time

TIME USED	LED COLOUR	MEANS	OPERATION
15 hours	Slow green blinking	The vacuum cleaner has been used 15 hours since the last receipt	Change/check the dustbag and press the receipt button for 5 seconds
0-399 hours	Green	Less than 400 operation hours	-
400 - 499	Orange	Over 400 operation hours	-
Over 500 hours	Red	Over 500 operation hours	-

4 - SELF CHECK

When the mains cable is connected, the circuit board performs a self check. When everything is ok, the LED blinks quickly for a few seconds.

5 - SHUT OFF DELAY

The shut off has a two (2) second delay so that the pipe work and hose are surely emptied after the switch off.

6 - RESET/DEMO SWITCH *6

Makes the following operations:

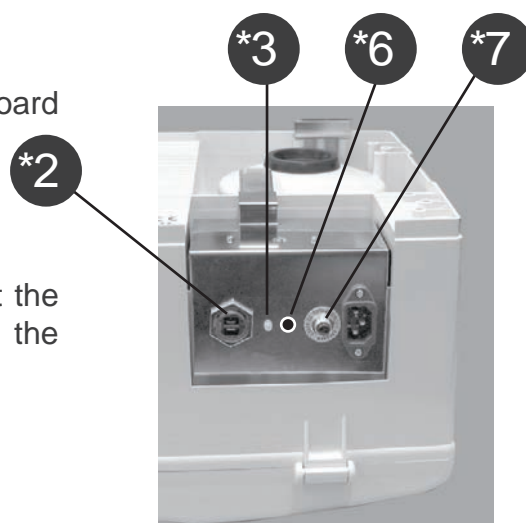

Function	Operation	Result
Test/demo	Press and release the switch in less than 5 seconds.	The card performs a self check and goes through all the phases of the previous table (see table 1)
Partial reset	Press the switch for over 5 seconds when the motor is not running.	The system will reset the 15 hours' countdown and the blinking LED (3) returns to the continuously on mode.
Total reset	Press the switch over 30 seconds when the engine is running.	The system reset the total time calculation.

7 - AUTOMATIC FUSE*7

The circuit board is equipped with an automatic fuse, (the button with the text "circuit breaker"). The reset takes place by pushing the button.

THE INSTALLATION OF ADDITIONAL SUCTION OUTLETS

1. In case additional suction outlets are installed to the system, remove the plug in the upper corner of the unit. This way you can take an additional box from the filter unit e.g. behind the wall or to other rooms.



2. When using the original 42 mm polypropylene pipe, first place a washer to the hole. The installation can also be started with the corner pieces.



3. Connect the weak current connection of the additional outlet to the terminal block behind the wall rack.

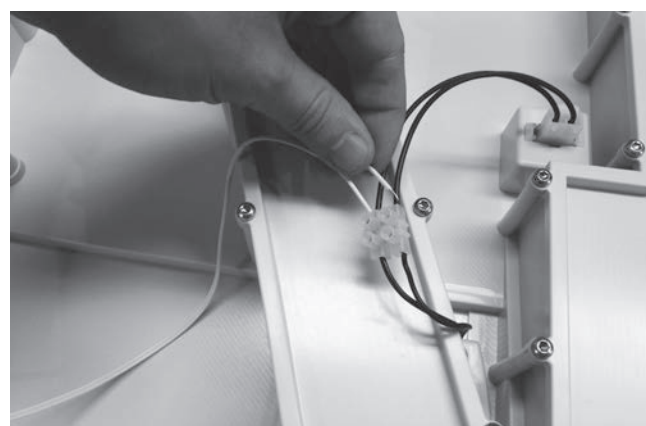

INFORMATION

In case you need any help with planning and installing your central vacuum system, please contact the retailer or manufacturer in the address below.

Manufacturing and marketing:

KP-TEKNO OY

Masalantie 365, 02430 Masala
tel. +358 9 296 5070, fax +358 9 221 5932
e-mail: puzer@puzer.fi, www.puzer.fi

www.puzer.fi Puzer central vacuum cleaner - Genuinely Finnish!

